

Upper Gough Street

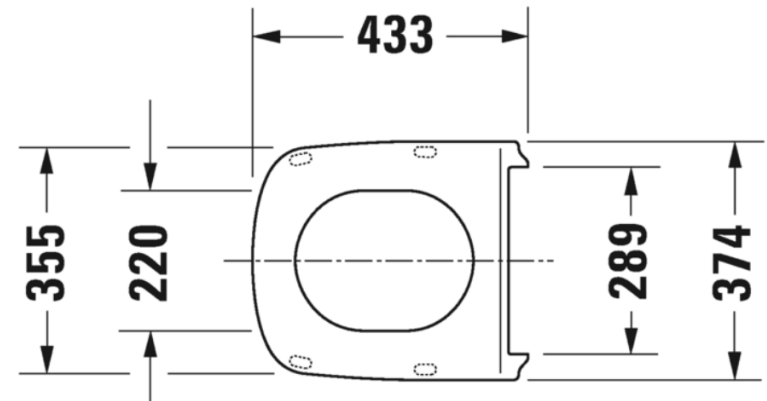

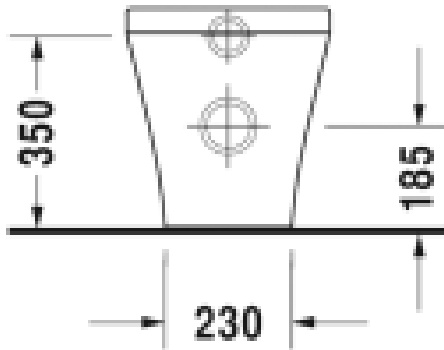
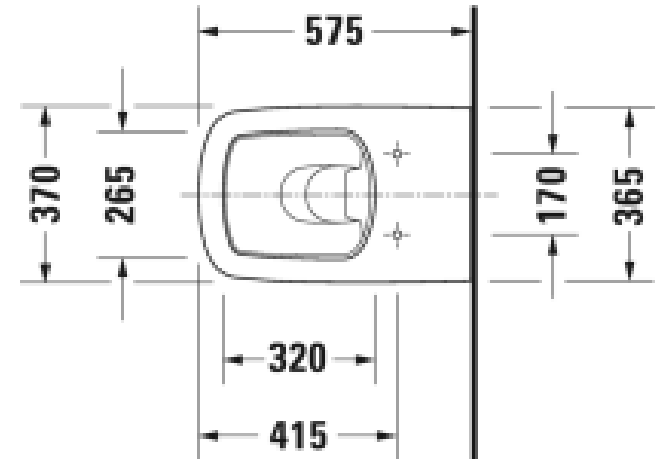
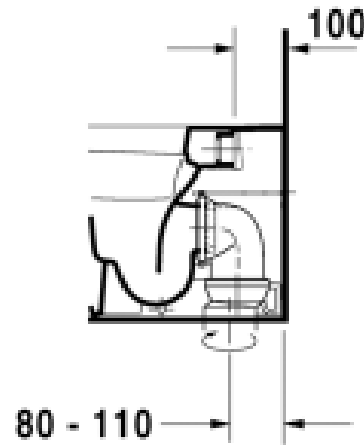

Five-year warranty

💧 4,5 litre flush

C.P. HART
CONTRACTS

215009 DURASTYLE FLOOR STANDING BTW PAN 370X570MM WHITE

6379 DURASTYLE SOFT CLOSE TOILET SEAT AND COVER WHITE

- > Clean the surface with a clean damp cloth. Use a toilet brush as normal to clean your toilet.

Tip! Place a cloth soaked with cleaning agent on the soiled area in the case of stubborn soiling and allow it to take effect.

- > Rinse with clean warm water to remove all traces of the cleaning agent and dirt.
- > Dry the surface.
- > Do NOT use the following cleaning agents:
 - Acidic cleaning agent (pH < 6) (e.g. lemon-based cleaner)
 - Solvent-based cleaning agent (e.g. methylated spirit, alcohols, acetone)
 - Chlorine-based cleaning agent (e.g. toilet cleaner)
- > Follow the cleaning agent manufacturer's instructions for use.
- > Only use cleaning equipment that is intended for the application (NO high-pressure washers or steam cleaning machines).

Five-year warranty

💧 4,5 litre flush

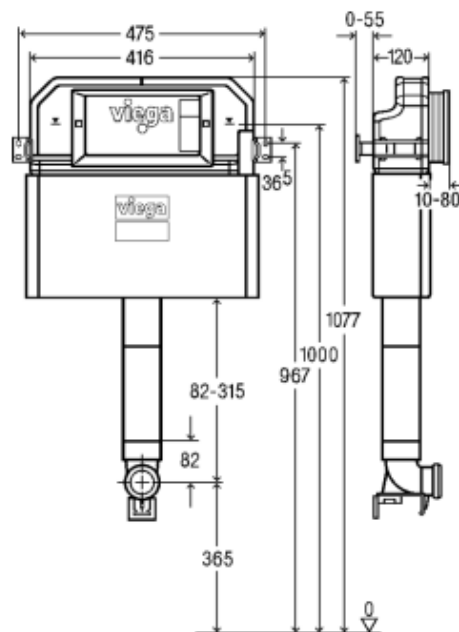

Cleaning and maintenance of the concealed cistern



WRAS Approval Number: 2103302

6 / 3 Litre Flush

The concealed cistern is constantly under mechanical, chemical, and physical stress. For this reason, the components must be cleaned as required, and the drain and filling valve seals renewed.

In areas or regions with hard water due to high concentration of calcium or magnesium salts, there is the risk of limescale deposits developing on the inlet and drain valves. The valves may have to be replaced, depending on the extent of the deposits.

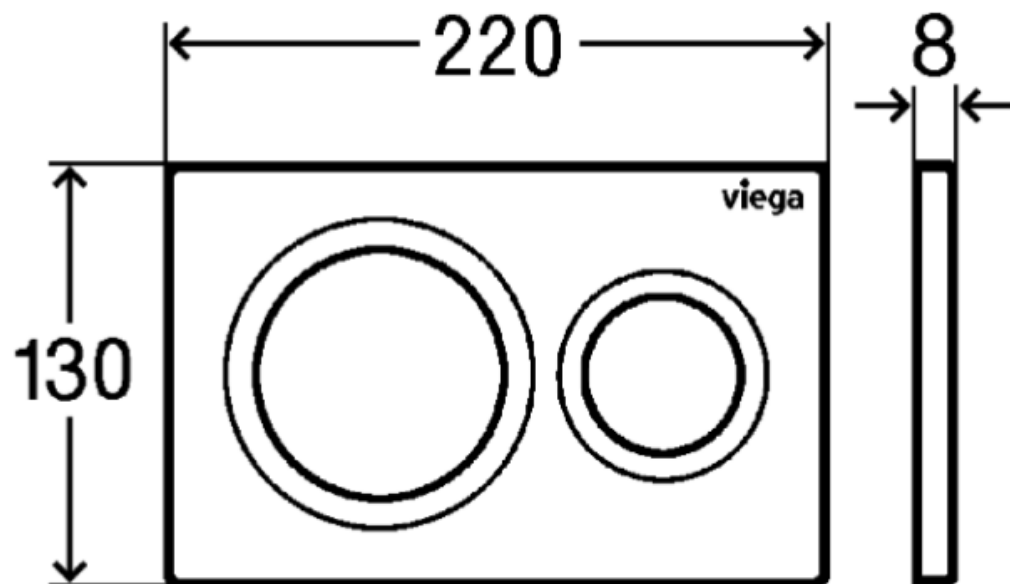
The Viega logo consists of the word "viega" in a bold, lowercase, sans-serif font, colored yellow, set against a black rectangular background.

Use normal soap or a mild cleaning agent for regular care and prevention of lime scale on the flush plate. Under no circumstances should scouring agent or scratching objects be used.

Strong stains can be removed using typical household cleaner. Rinse the detergent thoroughly with clear water after the prescribed exposure time. There should be no residue on the components.

WARRANTY
(25) years

C.P. HART
CONTRACTS

773779 VIEGA DUAL FLUSH PLATE CHROME

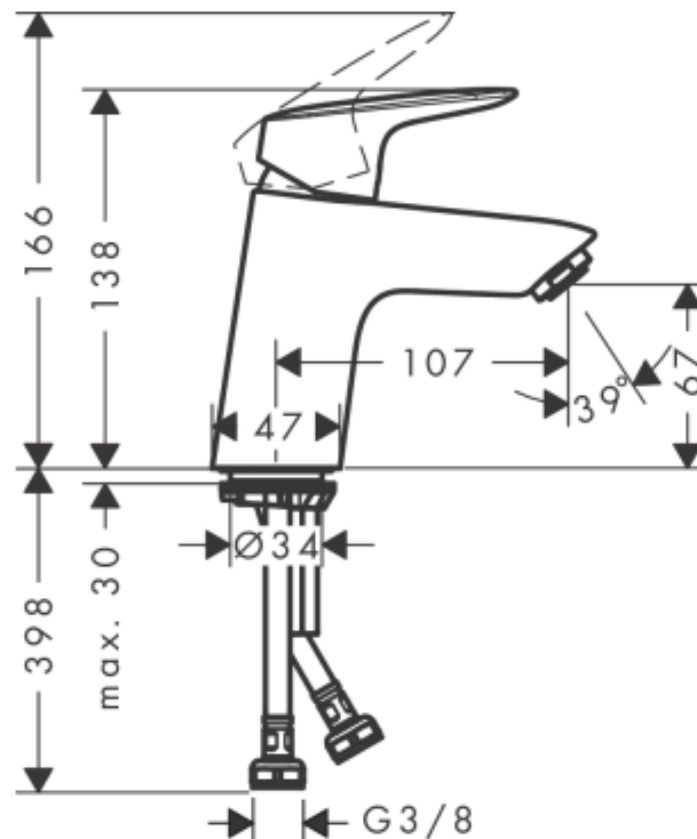
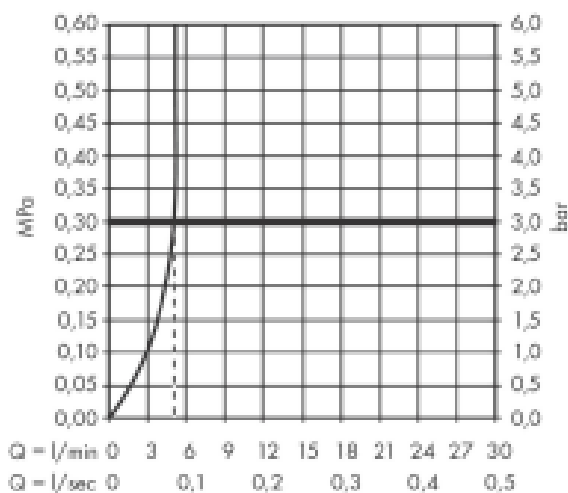

WRAS 2107044

Five-year manufacturer's guarantee

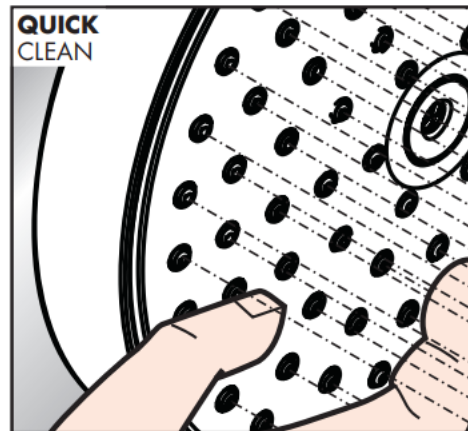
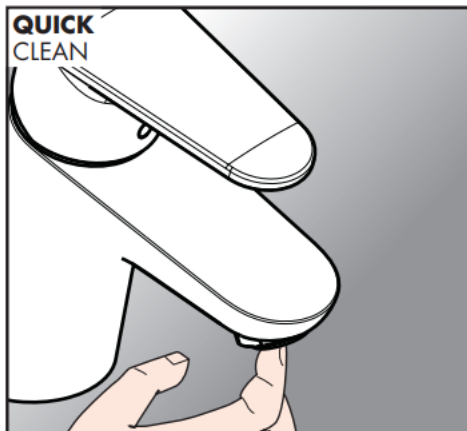
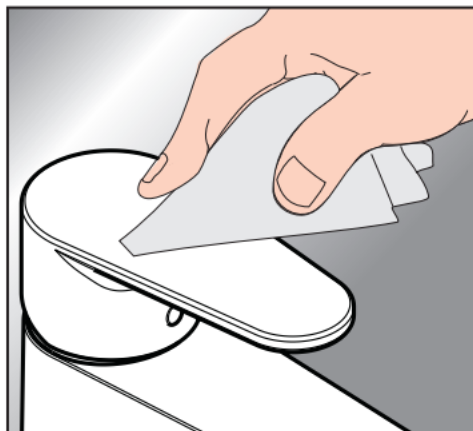

Cleaning bathroom furniture

- For gentle cleaning of bathroom furniture, we recommend a clean, soft, damp cloth (not a microfibre cloth!). Spilled substances should be removed immediately. Particularly stubborn stains (grease, cosmetics, etc.) can be removed without leaving any residue using 1% soapy water or washing-up liquid. Then rub the surface dry. Make sure that no drip residue remains on the edges and backs. As a general rule, do not use scouring agents or care products containing alcohol to care for high-gloss surfaces.
- High-gloss surfaces harden completely within 3 weeks after removing the protective film. Please handle with special care during this period and do not clean or wipe.

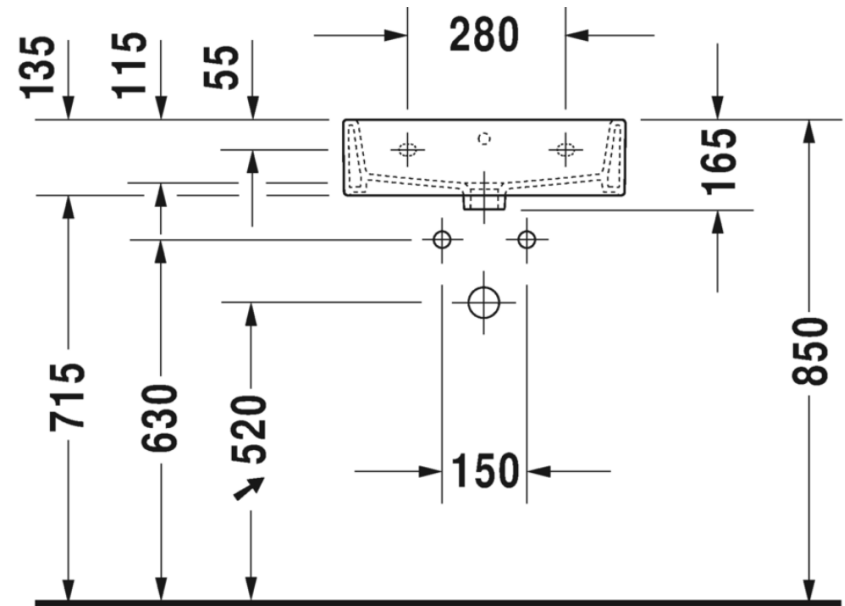
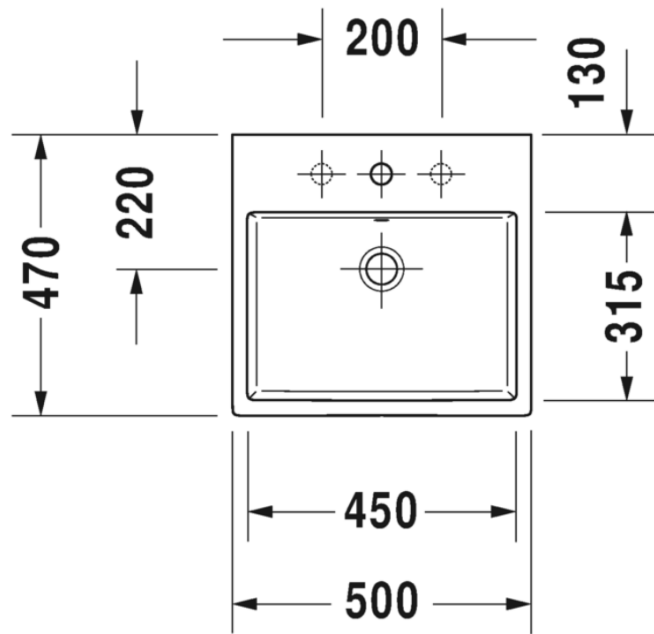

Five-year warranty

- > Clean the surface with a soft clean cleaning cloth and warm water.
- > When tackling stubborn dirt, wait a few minutes to allow the cleaner to take effect.
Tip! An advantage of using gels and foaming cleaners is that they also adhere well to sloping surfaces. You can also soak a cloth in the cleaner then place it on the soiled area.
- > Rinse with clean warm water to remove all traces of the cleaner.
- > Dry the surface.

Regularly clean the coated surface, or clean immediately if soiled. If the cleaning is not carried out regularly enough, soiling, e.g. limescale and soap stains, cosmetic residues, rust and mould, may become visible and subsequently more difficult to remove.

Five-year warranty

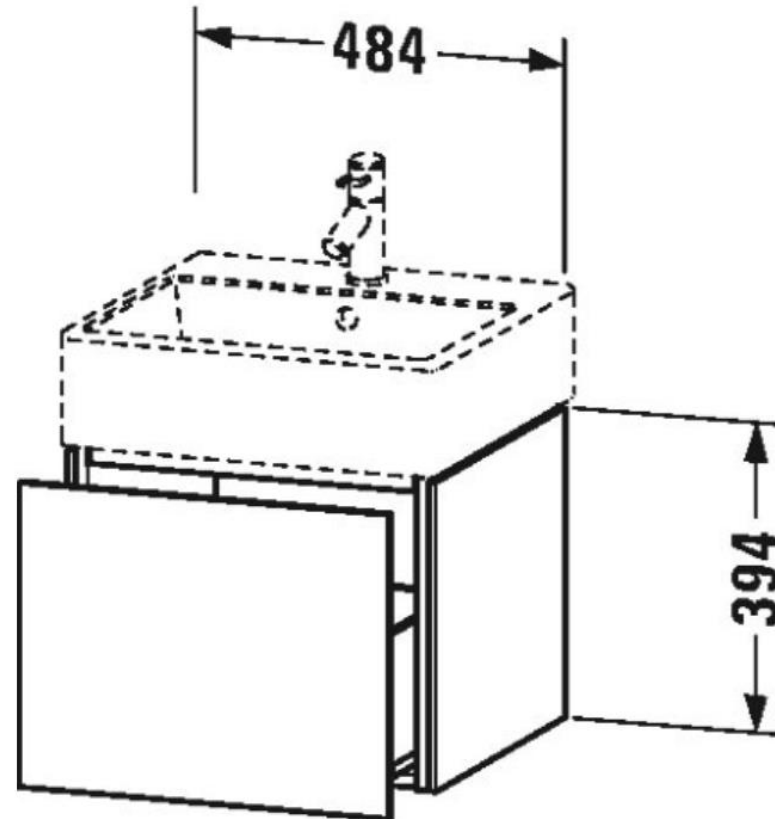

Five-year warranty

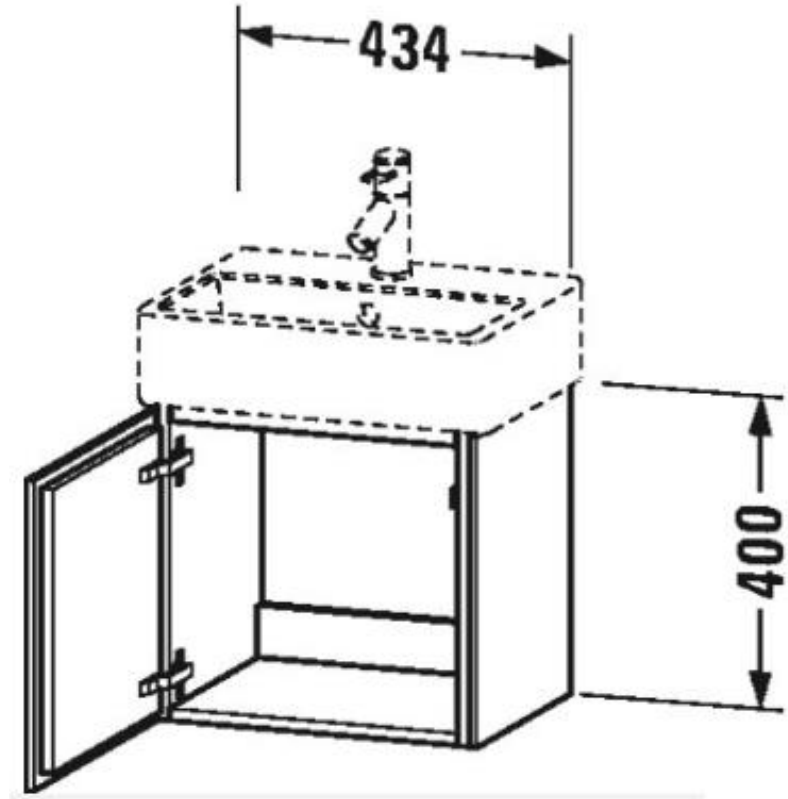

Five-year warranty

Duravit bathroom furniture is made of materials that are suitable for bathrooms. The following points must be strictly observed to ensure that you are able to enjoy using Duravit products for a long time: It is important to ensure good ventilation in the bathroom. Furniture should not be exposed to standing water or sustained moisture. However, if you notice splashes of water, dry the furniture to reduce the risk of damage. Avoid contact with pointed, sharp or abrasive objects. Chemicals, such as nail polish remover, perfume, hair dye / tint, solvent-based liquids, acetone etc. should be removed from furniture surfaces immediately. Never use abrasive care products, solvents or aggressive cleaning agents for cleaning. Ink, fruit and felt-tip pen stains, tea, coffee, juice and red wine must be removed immediately, otherwise it will permanently affect the surface.

Remove soiling immediately. Recent soiling is much easier to remove from the surface than when it is dried in. All surfaces have limited UV resistance. Changes in colour may occur if the products are exposed to continuous UV radiation.

The following sections are split into individual materials as regards their care and maintenance.

IMPORTANT NOTE

You should carefully read the recommendations for use provided by your cleaning agent manufacturers. If in doubt, you can test the cleaning agent and care product in an inconspicuous area.

CARE AND CLEANING OF REAL WOOD VENEER OR SOLID WOOD

Real wood veneer is a living material. Its structure, grain, porosity and colour vary naturally which proves the authenticity of the natural wood material. The colour and lustre of wood

may change if it is exposed to sunlight over time; this variation is therefore not a justified complaint. Use a slightly damp, soft lint-free cloth or chamois to regularly remove dust. Remove heavier soiling with hot water and detergent if necessary. Wipe off water deposits immediately with a soft cloth. Please use an all-purpose cleaner with the following ingredients to remove soiling from large-pored real wood veneers (walnut, oak): anionic and nonionic surfactants, soap, phosphonates, phenoxyethanol. Rub the cleaning agent in a circular motion and then lengthways into the pores with a cloth. Then wipe with a soft cloth moistened in warm water. Rub polish into the surface first with heavier soiling of the pores and then clean with an all-purpose cleaner as described above. Apply only a small amount of furniture polish to the dry surface; never apply to a damp surface as the polish may whiten.

CARE AND CLEANING OF HIGH-GLOSS LACQUERED SURFACES

Clean the bathroom furniture with a soft cloth moistened in warm water and a little detergent. Use non-abrasive car polish very sparingly for heavier soiling that cannot be removed with a cloth. Use only in exceptional cases as the lacquer coating becomes thinner with frequent use. Do not use furniture polishes (oils, waxes). These leave a greasy film on the surface and reduce the lustre. Dry cloths, paper serviettes or microfibre cloths should be avoided on matt or high-gloss surfaces as the surface may be scratched.

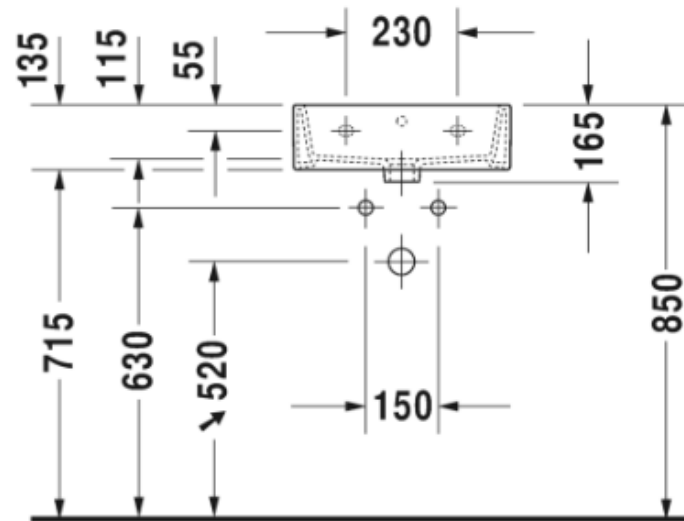
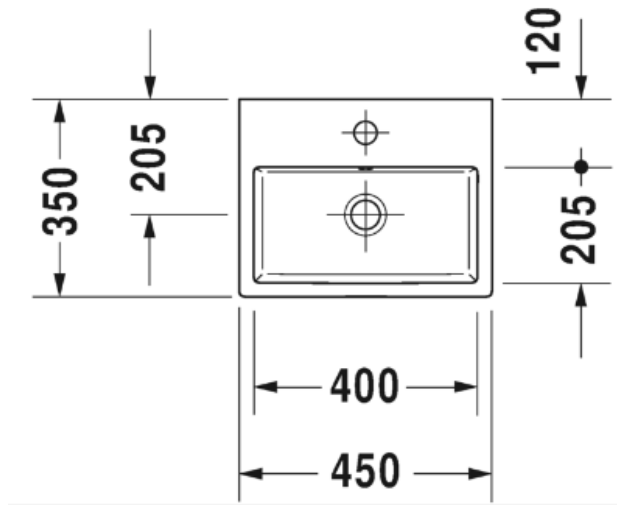

Five-year warranty

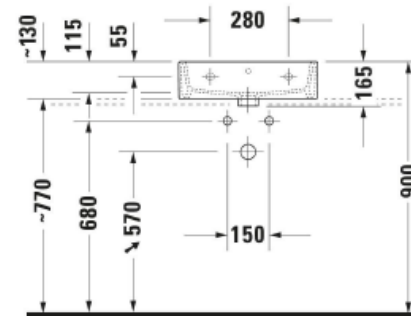
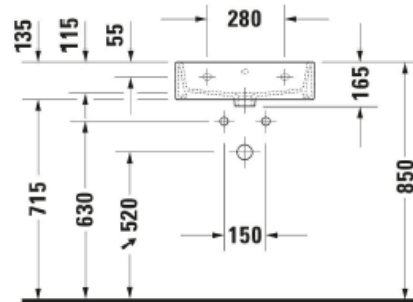
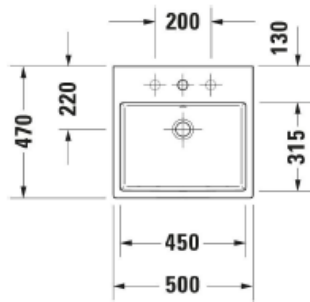

Five-year warranty

Care instructions

Ceramic has many positive properties: it is resistant to heat and cold, abrasion and scratch-resistant, light-fast and hygienic. As a natural raw resource, it is completely safe to use and also extremely durable.

Please observe the following cleaning and care instructions so that you can enjoy your ceramic for as long as possible:

Which cleaner?

NOTICE!

Damage to the surface due to incorrect cleaning!

- Only use cleaners and equipment that are suitable for the application.
- Follow the manufacturer's instructions for the cleaner.
- **Never** mix cleaners.

A mild commercially available sanitary cleaner is suitable for **daily cleaning**, limescale stains can be removed using an acidic vinegar or citrus based cleaner (pH value 1-4). The harder the water is, the greater the quantity of cleaner that should be used.

Metallic marks resulting from use (black dots/lines, e.g. due to rubbing of rings) cannot be removed using mild cleaners. Only treat the affected area with Stahlfix (German brand) or equivalent stainless steel cleaner, car polish or a ceramic hob cleaner.

How often?

Regularly clean the coated surface, or clean immediately if soiled. If the cleaning is not carried out regularly enough, soiling, e.g. limescale and soap stains, cosmetic residues, rust and mould, may become visible and subsequently more difficult to remove.

How?

- > Clean the surface with a soft clean cleaning cloth and warm water.
- > When tackling stubborn dirt, wait a few minutes to allow the cleaner to take effect.
Tip! An advantage of using gels and foaming cleaners is that they also adhere well to sloping surfaces. You can also soak a cloth in the cleaner then place it on the soiled area.
- > Rinse with clean warm water to remove all traces of the cleaner.
- > Dry the surface.

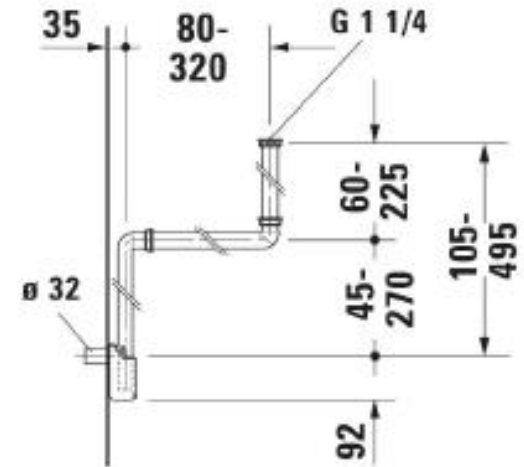
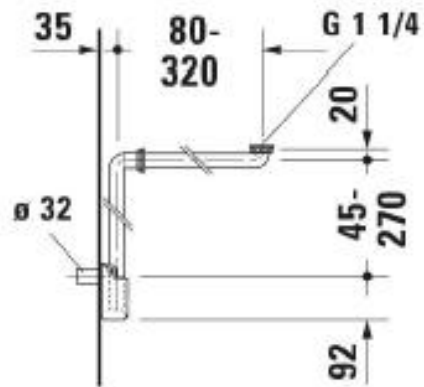

Five-year warranty

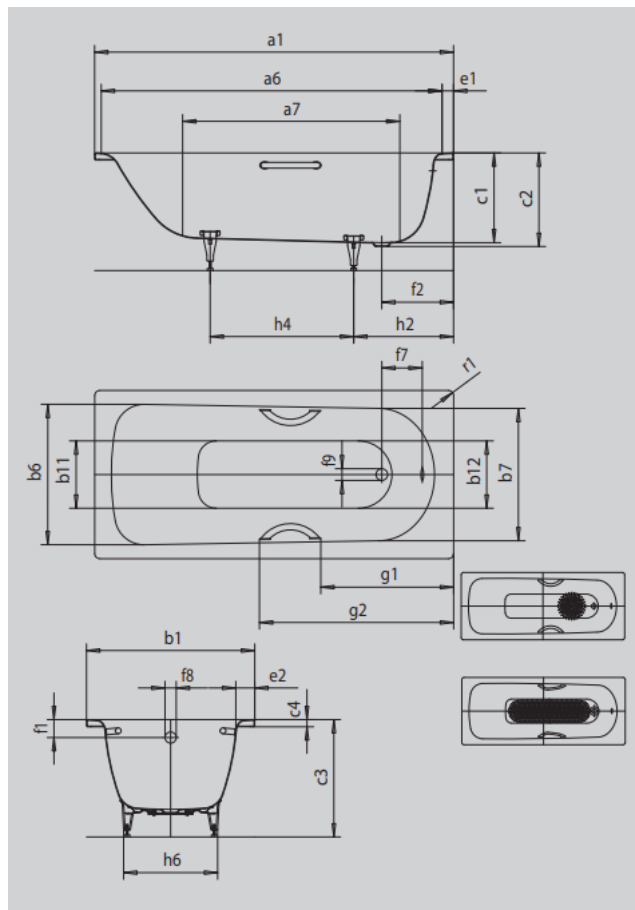

**CARE INSTRUCTIONS****KALDEWEI steel enamel**

- After use, rinse the enamel surface with water and wipe with a soft, damp cloth, chamois or sponge.
- Dry dark coloured products after use to prevent calcium build-up.
- Remove small stains with a regular household detergent or a mild all-purpose or bathroom cleaner; soak heavier stains before cleaning. Always follow the instructions on the cleaning product.
- To avoid calcium deposits, ensure that all fittings are properly sealed and that all water is removed after use. Any deposits that do occur despite these efforts can be removed with a lukewarm 1:1 mixture of water and vinegar (do NOT use concentrated vinegar). After cleaning, rinse the surface thoroughly.
- Personal hygiene products containing naturally occurring oils or fats, such as hair conditioners, shower and bath oils, may leave residue on the enamel surface that will increase the risk of slipping. Use a fat-removing alkaline cleaner to remove these stains and follow up with an acidic cleaner before rinsing the surface with clean water.
- When using a drain cleaner, please read the manufacturer's instructions carefully and pour the cleaner directly into the drain. Take care not to splash drain cleaner onto the enamel surface and remove splashes promptly.
- Always observe the care instructions for the fittings on your product.
- Do not use coarse, abrasive cleaning products, strong acidic or alkaline cleaners (not suitable pH <2/>5 and <8/>10, e.g. concentrated vinegar, chlorinated alkaline cleaners), steel wool, scouring pads, laundry detergents and washing powder or laundry detergent/washing powder suds.
- Surface damage caused by incorrect treatment can often be repaired using the KALDEWEI Enamel Pen or the KALDEWEI Enamel Set.





CARE INSTRUCTIONS

Clean with warm soapy water followed by rinsing with clean water and drying with a soft cloth. All finishes are vulnerable to acid attack and some strong substances such as household cleaners or disinfectants can cause surfaces to go black or peel.

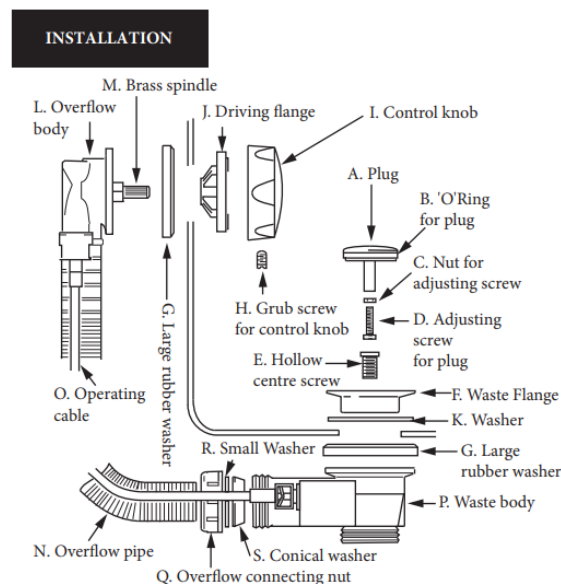

- 1) Check and familiarise yourself with all of the components.
- 2) Offer up the main body of the pop up waste (items L, O and P) to the bath, ensure both washers (item G) are in place.
- 3) Secure the overflow body, assemble the driving flange (item J) to the overflow body (item L). Before tightening this centralise the assembly into the centre of the bath overflow hole. Do not over-tighten or use excessive pressure.

- 4) Secure the waste outlet, apply silicon sealant to the area around the waste outlet hole in the bath, then place into position the foam washer (item K) and the waste flange (item F). Fit and tighten the hollow centre screw (item E). Take care not to damage the plated finish and do not over-tighten. Check that the operating cable (item O) is not bent or kinked and has some free movement.
- 5) The plain end of the overflow pipe (item N) fits to the overflow body (item L), this is a push on connection. The corrugated end of the overflow pipe fits to the waste body (item P). To make this connection assemble the connecting nut (item Q), the small washer (item R) and the conical washer (item S) onto the overflow pipe. Fully insert the overflow pipe into the connection on the waste body and tighten connecting nut.
- 6) Take the control knob (item I) and ensure the grub screw (item H) is fitted into this. Fit the control knob onto the brass spindle (item M) with the access hole in the control knob at the bottom. Tighten the grub screw, through the access hole.
- 7) Assemble the pop up plug, fit the nut (item C) onto the adjusting screw (item D) and fit this to the stem of the plug (item A). Fit the 'O' Ring (item B) to the plug. Turn the control knob so that the operating lever is in the closed position. The operating lever is part of the waste body (item P) and is located just below the grid section. To be in the closed position the lever should be in its lowered position. Set the adjusting screw in the plug so that it is almost touching the operating lever. Operate the control knob to check that the plug 'pops up' sufficiently to allow the water to be drained from the bath. Tighten the nut (item C).
- 8) Fill the bath with water and check all joints to ensure there are no leaks. This is best done in stages starting with a small amount of water before fully filling the bath.
- 9) Once fitting has been completed carefully clean all plated surfaces. The finished surfaces on this product are hard and durable and should be cleaned on a regular basis to maintain their appearance. They should only be cleaned with warm soapy water and then wiped with a dry cloth. Under no circumstances should any aggressive or abrasive cleaning agent be used, as this can lead to a deterioration of the high quality finish.

Five-year manufacturer's guarantee



bemodern®

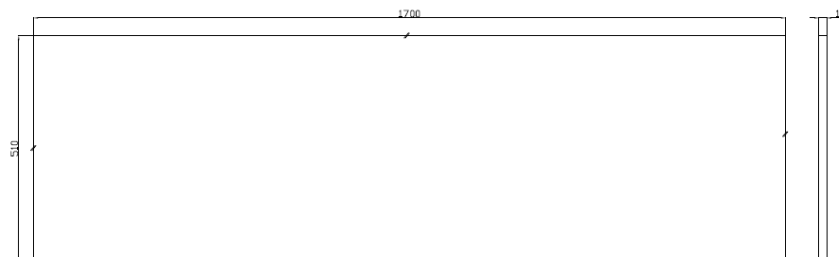

Bath Panels

BFP BQFP BFP

Note: Baths will have their own installation instructions supplied by the manufacturer. Before attempting to fit your panels, please read these installation instructions in full and ensure that you fully understand them.

ALL PANELS ARE SUPPLIED 450mm IN HEIGHT.

FIG.1

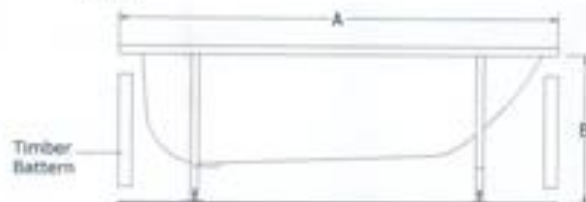
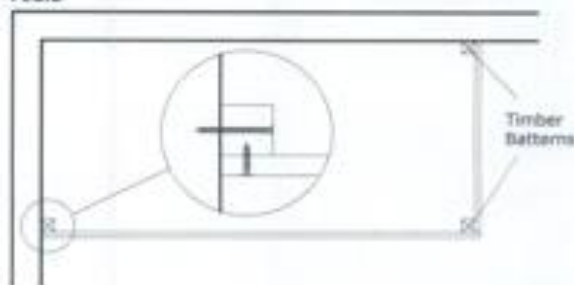

FIG.2



1. To install the bath panels, measure the length and height of the bath to determine the size for the bath panels. **FIG.1.** Secure a square timber batten to the walls at both ends underneath the rim of the bath. **FIG.2**
2. The bath panel is then fixed to the square timber batten. This can be achieved in many ways, i.e. strong adhesives, silicone, liquid nails, panel pins, screws and screw cups or mirror screws, depending on the installers preference.
3. Whichever method of fixing is used, please note it may be necessary at a later date or due to unforeseen circumstances that you may need to remove the panels.
4. If a return panel is required you will need to assemble panels into an (L) Shape, use a square timber batten to join panels in the corner. **FIG.2**

Note: Some designs are supplied at 700 & 750, however some are supplied at 750 only and will require reducing in length.

It is important that all edges, gaps and joints must be sealed with a waterproof agent.

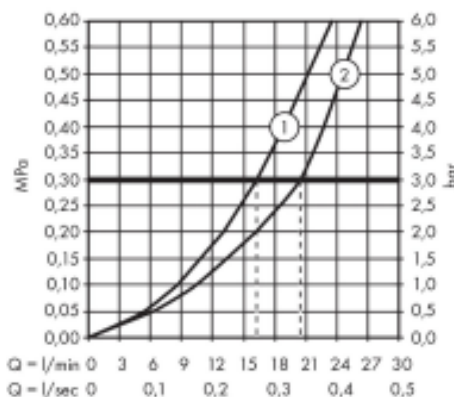

Only use cleaning material which is explicitly provided for this type of application.

Never use cleaning materials, which contain hydrochloric acid, formic acid, concentrated caustic soda, chlorine pale lye or acetic acid, as they cause considerable damage.

Phosphorus acidic cleaners are only conditionally applicable.

Mixing cleaning agents is not permitted, generally.

Never use cleaning materials or appliances with an abrasive effect, such as unsuitable cleaning powders, sponge pads or micro fibre cloths.

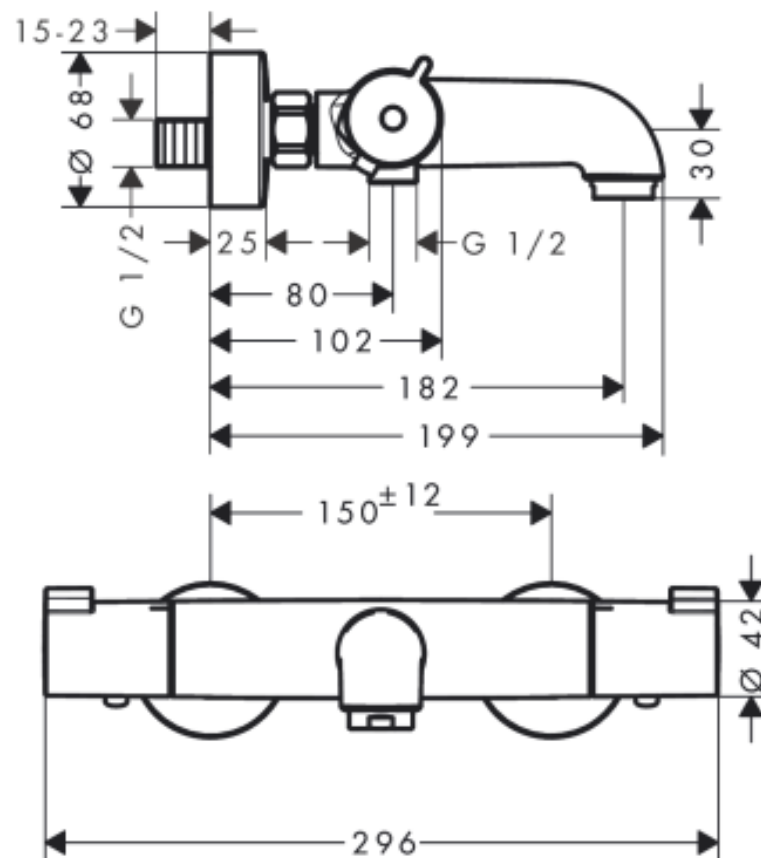

Five-year manufacturer's guarantee

1809030

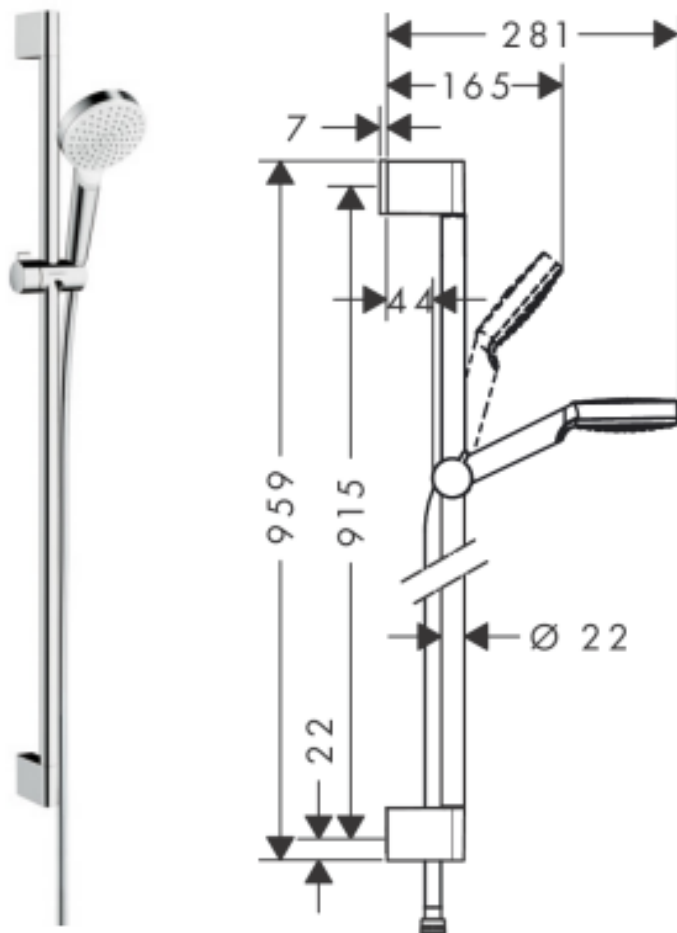

Only use cleaning material which is explicitly provided for this type of application.
 Never use cleaning materials, which contain hydrochloric acid, formic acid, concentrated caustic soda, chlorine pale lye or acetic acid, as they cause considerable damage.
 Phosphorus acidic cleaners are only conditionally applicable.
 Mixing cleaning agents is not permitted, generally.
 Never use cleaning materials or appliances with an abrasive effect, such as unsuitable cleaning powders, sponge pads or micro fibre cloths.

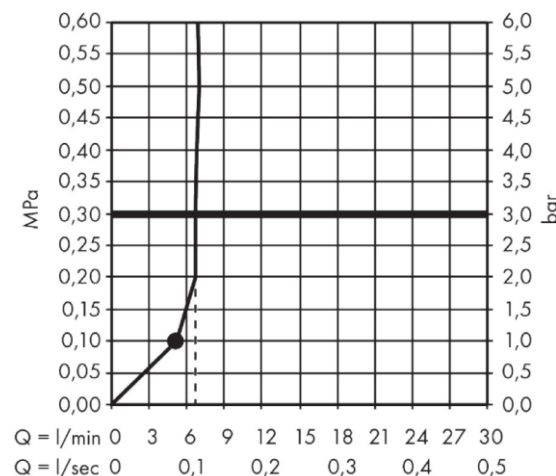

Five-year manufacturer's guarantee

1901002

1907326

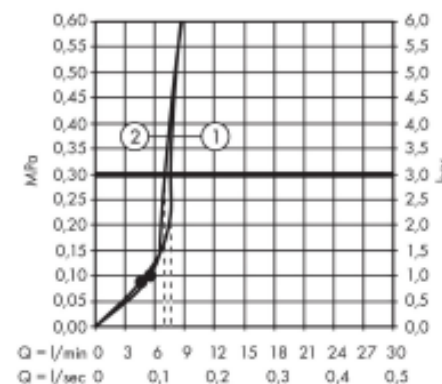

Only use cleaning material which is explicitly provided for this type of application.

Never use cleaning materials, which contain hydrochloric acid, formic acid, concentrated caustic soda, chlorine pale lye or acetic acid, as they cause considerable damage.

Phosphorus acidic cleaners are only conditionally applicable.

Mixing cleaning agents is not permitted, generally.

Never use cleaning materials or appliances with an abrasive effect, such as unsuitable cleaning powders, sponge pads or micro fibre cloths.

Five-year manufacturer's guarantee



Height: 1360mm
Width: 820mm
Glass Thickness: 5mm
Adjustment: 810-825mm
Frameless with radius glass
Reversible for left or right hand applications
Suitable for all standard bath mixer and electric showers



H4S14CS HAVEN SLIDING DOOR 1400

SPECIFICATIONS:

- Chromed brass handle
- Bright Silver frame
- 'Minimal' low profile seals
- Smooth running 'quick release' roller bearings
- 25mm vertical adjustment in each profile
- Reversible for left or right hand fixing



Code	Size (mm)	Aperture (mm)	Adjustment (mm) Alcove Fitting	Adjustment (mm) With Side Panel
H4S10CS	1000	360	940 - 990	957 - 1007
H4S11CS	1100	410	1040 - 1090	1057 - 1107
H4S12CS	1200	460	1140 - 1190	1157 - 1207
H4S14CS	1400	560	1340 - 1390	1357 - 1407
H4S15CS	1500	610	1440 - 1490	1457 - 1507
H4S17CS	1700	710	1640 - 1690	1657 - 1707



Our products are generally maintenance free, however it may be necessary to lubricate wheel assemblies and other moving parts from time to time.

It is strongly recommended that a quality silicone spray is used.

A list of Dont's:

1. Don't use acidic based products which are unsuitable for cleaning enamel surfaces.
2. Don't use abrasive cleaners or cleaners using bleach or solvents, these products will adversely affect the finish of the aluminium profiles.
3. Don't use scouring pads, powder or any sharp instruments when cleaning the enclosure.





fusion Rectangle

- ⑥ 1400x700mm
- ⑥ 1400x800mm ■▲
- ⑥ 1400x900mm ■

JT

fusion Leg Detail



• 45mm High



- The shower tray should be cleaned regularly with warm, soapy water only and dried with a soft cloth. Never use scourers, abrasives, bleach or other chemical cleaners.

Shower Tray Customer 25 Year Guarantee

Just Trays Ltd guarantees all JTFusion™ shower trays against faulty materials or manufacture for a period of 25 years from date of installation, provided that it has been installed, used and maintained in accordance with the manufacturers instructions. If in our opinion the product fails under those circumstances, Just Trays Ltd will undertake to repair or replace the product at our option. Should a claim arise, we request that the following conditions be satisfied. 1. Proof of purchase at the time of claim. 2. The product has been fitted/installed in accordance with our fixing instructions, local by laws and general good plumbing practice. 3. The product has been maintained and cared for in accordance with our instructions. If in our opinion the product has been modified, misused, neglected, wilfully or accidentally damaged, we can accept no responsibility for failure. 4. Just Trays Ltd must be given the opportunity to inspect the product in the installed condition. Should Just Trays Ltd carry out work as a result of a claim but subsequently it is revealed that the product has been abused or improperly installed, we reserve the right to charge the customer for all expenses incurred. The liability of Just Trays Ltd is limited to the product supplied by Just Trays Ltd, and does not extend to consequential loss or damage arising from the defective product. All aftersales enquiries must be directed to the stockist where the product was purchased. Just Trays Ltd believes in continuous improvement. If in our opinion the product has failed under the terms of the guarantee and a replacement is offered but identical goods are no longer available, Just Trays Ltd will replace it with our nearest equivalent product. This guarantee, which is effective for products purchased after September 2009, states our entire liability and is offered to customers acquiring our products as consumers, not in the course of trade or business. This guarantee does not affect your statutory rights. This guarantee is only applicable in the UK and Republic of Ireland.



Focus MD001 1200x500	Height: 1200 Width: 500 Depth: 93 Weight HO: 10.5 kg EO: 18.5 kg	Tube ϕ : 25 + 30x40 D Section Pipe Centres: 455 Elec. element if specified: 300 Output @ 50°C Δ T Watts: 428 BTUs: 1466
	All dimensions in millimetres	Manufactured from Mild Steel

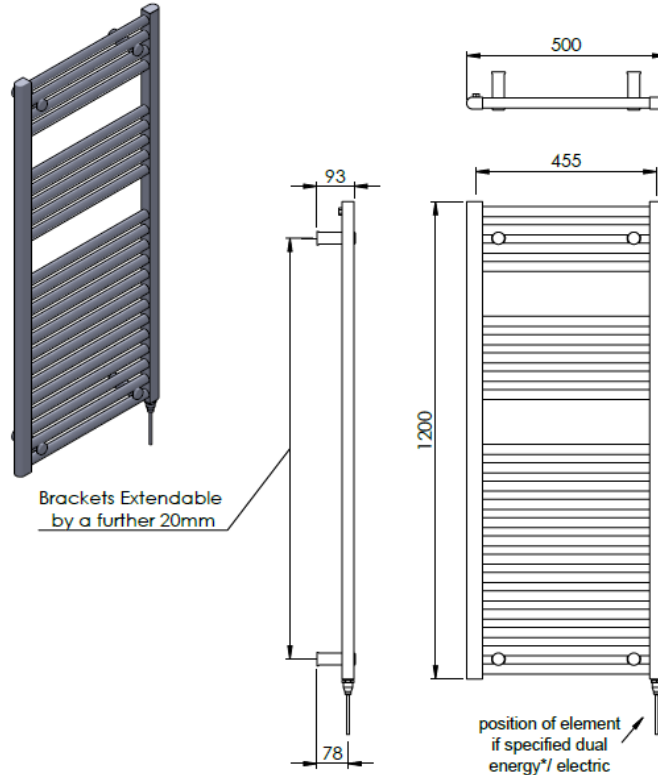

Heat Sensor Element

15

15 Year Guarantee



Heat Sensor Element

Functionality

The heater offers five temperature settings ranging from 30°C to 60°C. An electronic temperature sensor ensures precise temperature control. The device displays the temperature to which it is currently set and indicates the status of the heating cycle. The heating element has very low power consumption when in standby mode.

Dryer/Timer Function

The dryer function allows the user to set a higher heating power for two hours, after which, the heater will revert to its previous state. By switching the device on using dryer/timer button user activates MOA's timer function. The device will heat for 2 hrs at freely selected setting and then switch off automatically.

Adjustable Temperature Span

An option to change default temperature heating span from 30-60°C to 4 other settings: 30 - 45°C, 30 - 50°C, 30 - 55°C and 30 - 65°C

Intelligent Home Systems

In the event of a power failure the heating device remembers the most recent settings used, which makes it suitable for connection to external timers or intelligent home systems.

Safety

The heater has an active safety feature which initiates in the event of dry radiator operation. The heating element is equipped with temperature sensor and thermal fuse (double overheating protection) and offers frost protection (ANTIFREEZE). The heater will display warning indicators in the case of malfunction.

Design

A heater with a straight cable, without a plug, is supplied with a cable masking cover.

Colour

Available colours: white, silver, chrome and black. The heating element is also offered in any RAL colour and Terma special colours (including brass and gold), subject to a minimum order of 100 pcs per colour.

The heating element range

Power [W]	heating element length
120	315
200	275
300	300
400	335
600	365
800	475
1100	565

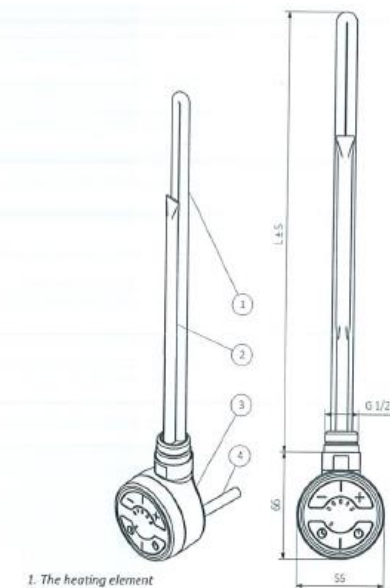

1. The heating element
2. Temperature sensor
3. Sealing head
4. Power cord

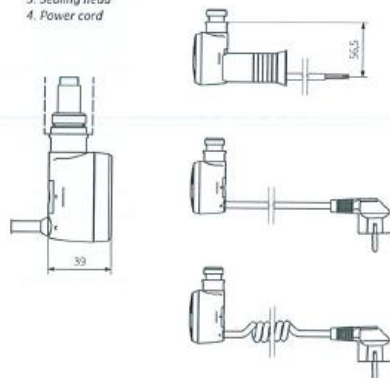

Heater

Cable	Ingress protection	Radiator connection	Power	The heating element
straight cable with plug	IP x5	1/2"	230 V 50 Hz	Class I
straight cable without plug	IP x5	1/2"	230 V 50 Hz	Class I
spiral cable with plug	IP x5	1/2"	230 V 50 Hz	Class I

15

15 Year Guarantee

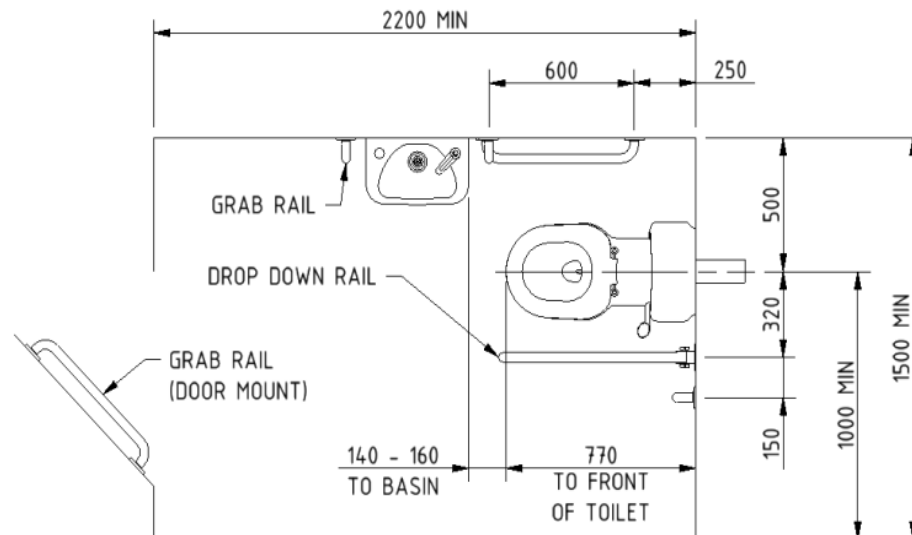

FLOW RATE CURVE

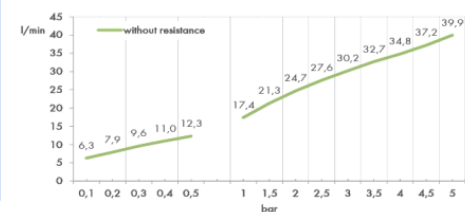

FLOW RATE & HYSTERESIS CURVES

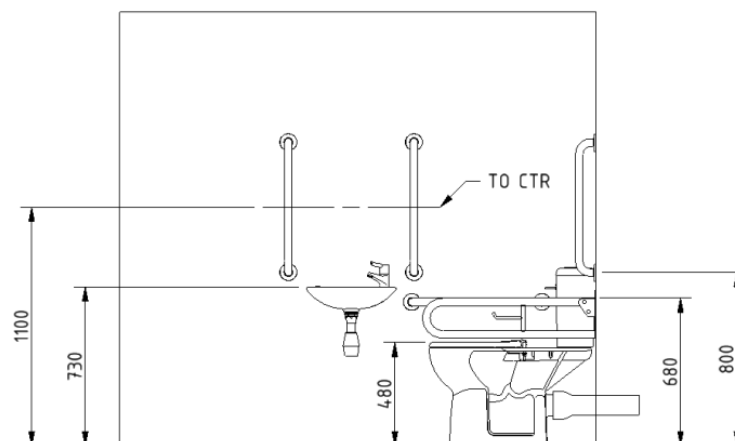
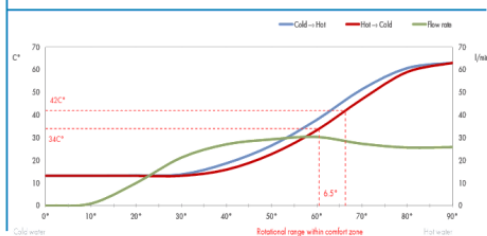



Product details

Warranty:	Lifetime
Maximum load:	400 kg
Doc M compliant:	Yes
Suitable for wet areas:	Yes

Features

- Extended projection to comply with Part M of the Building Regulations
- Rimless design for ease of cleaning
- Comfort height to allow easier side transfer from wheelchair
- UKCA & CE compliant
- Ceramic body

Close coupled minimal cistern tank



Product details

Warranty:	Lifetime
Max rated load:	n/a
Doc M compliant:	Yes
Suitable for wet areas:	Yes

Features

- Modern minimal design
- Complies with Part M of the Building Regulations
- UKCA & CE compliant
- Suitable for front lever
- Bottom inlet
- Universal - either left or right handed
- Lockable lid option



Product details

Warranty:	2 years
Max rated load:	n/a
Doc M compliant:	Yes
Suitable for wet areas:	Yes

Features

- Inlet valve and syphon Reg 4 Certified (WRAS, NSF, Kiwa, etc.)
- Can provide both full and half flush
- Doc M spatula lever to provide easy operation for users with limited dexterity

Ring only toilet seat



Product details

Warranty:	2 years
Maximum load:	n/a
Doc M compliant:	Yes
Suitable for wet areas:	Yes

Features

- Complies with Part M of the Building Regulations
- Anti-bacterial, strong and durable seat
- Ergonomic and comfortable shape
- Dedicated moulded buffers for best stability
- Strong stainless steel hinge
- Fits pan NY01-PANCC02-WH (Only compatible with this pan)

Product details

Warranty: Lifetime

Max rated load: n/a

Doc M compliant: Yes

Suitable for wet areas: Yes

Features

- Two tap holes for left or right handed configuration
- Compact design to maximise space for a wheelchair user
- Complies with Part M of the Building Regulations
- No overflow

Does not come with wall fixings (P-000248-X00X)



Polished chrome sequential basin mixer tap

Product details

Warranty: 2 years

Max rated load: n/a

Doc M compliant: Yes

Suitable for wet areas: Yes

Flexi tap tail connection
(to tap body): M10 Thread

Flexi tap tail
(onward connection): 3/4 Inch Diameter Thread

Features

- Reg 4 Certified (WRAS, NSF, Kiwa, etc.)
- Easy operation for users with limited dexterity
- Cold start



Round flange steel grab rail with exposed fixings, 35mm diameter tube



Product details

Warranty:	2 years
Max rated load:	200 kg
Doc M compliant:	Yes
Suitable for wet areas:	No

Features

- Complies with Part M of the Building Regulations
- Robust steel construction
- Durable epoxy polyester coated finish

Lift and lock steel hinged support rail with toilet roll holder



Product details

Warranty:	2 years
Max rated load:	115 kg
Doc M compliant:	Yes (800mm variant only)
Suitable for wet areas:	No

Features

- Lift and lock folding mechanism
- Integral toilet roll holder
- Robust steel construction
- Durable epoxy polyester coating
- Complies with Part M of the Building Regulations (800mm variant only)



Product details

Warranty:	2 years
Max rated load:	n/a
Doc M compliant:	Yes
Suitable for wet areas:	Yes

Features

- TMV3 approved & Reg 4 Certified (WRAS, NSF, Kiwa, etc.)
- Complies with Part M of the Building Regulations
- Building Regulations Part G compliant
- Highly resistant to scaling
- Anti-tamper proof head



Description

Armitage Shanks S047501 Birch 455mm Sink, Pad & Grating Pack

- White finish
- Size 46cm
- Low back heavy duty fireclay cleaners' sink
- The pack includes: S591501 Birch cleaner's sink 460 x 380mm with fitted bucket grating, S7190AA Alterna Quadrant ½" quarter turn bib taps with ceramic discs and lever handles, S8330AA Bib tap wall mount ½" for exposed plumbing (single), S8726AA Waste 1½" unslotted strainer waste, 80mm tail. brass, S892567 Trap 1½" plastic resealing bottle with 75mm seal, multi-purpose outlet and S9233MY Stainless steel legs 350mm high with screw to wall aluminium alloy bearers, 355mm overall, 305mm stud (pairs)

Specification

Product Guarantee:	Lifetime
Barcode:	5017830421535
Made In the UK:	No
Projection (mm):	390
Material:	Fine Fireclay
Style:	Traditional
Shape:	Rectangular
Number Of Tap Holes:	0



WINNER
RETAILER OF THE YEAR



**INDUSTRY
PARTNER**

C.P. HART
CONTRACTS